

**AMCA 260  
Tested &  
Certified**

## Mixed Flow Induced Flow Exhaust Fan – Model QIFE

The model QIFE fan is intended for use in exhausting laboratory fumes and hazardous chemicals. The air will be exhausted in such a manner that concentrated fumes will not be re-entrained into the building's intake or make-up air. The induced air dilutes the contaminated air and increases windband outlet volume to accelerate the discharge air for a high plume height, in applications such as:

- Laboratories
- Hospitals
- Schools
- Chemical Storage

### Standard Product Features

- Mixed flow wheel designs
- Three (3) discharge nozzles available (low, medium and high velocity)
- Induced flow windband
- Heavy duty coated steel curb cap
- Bolted access door
- Shaft seal
- Sealed belt tube

### Optional Features

- Mixing plenum box
- Bypass damper
- Isolation damper
- AMCA "B" or "C" spark resistant construction
- Special coatings
- Special materials of construction



The AMCA Certified Ratings Seal applies to Induced Flow Fan Air and Sound Performance tested in accordance with AMCA Standard 260.

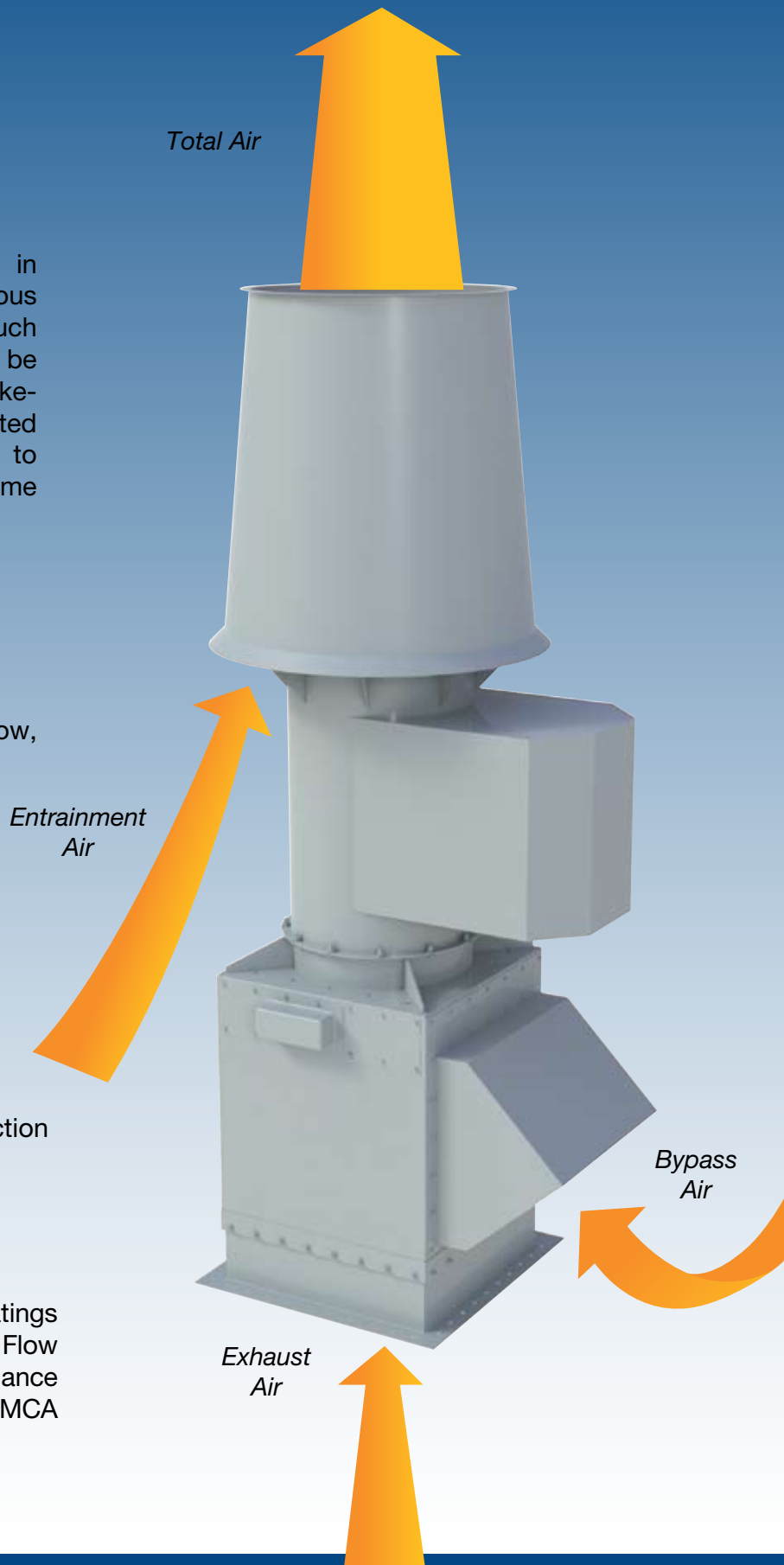

Twin City Fan's AMCA 260 Certified Induced Flow Exhaust Fan

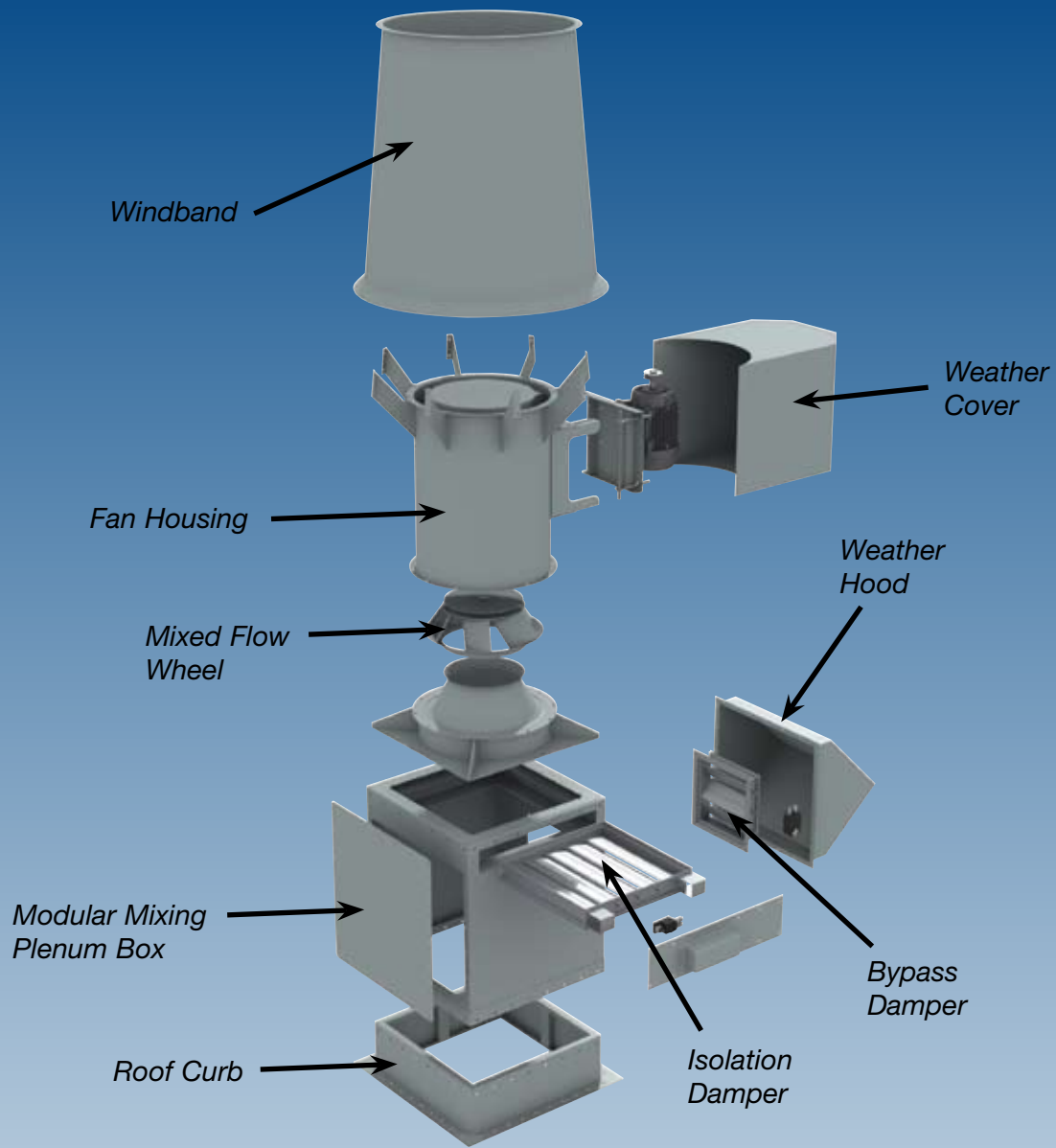

### Mounting Configurations

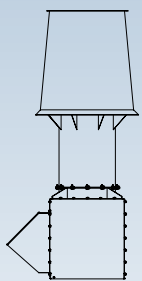

Single Unit

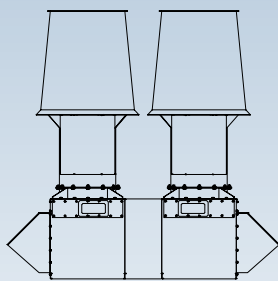

2 x 1 Double Unit

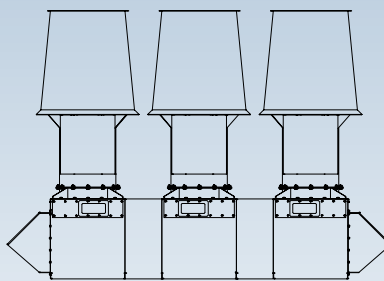

3 x 1 Triple Unit

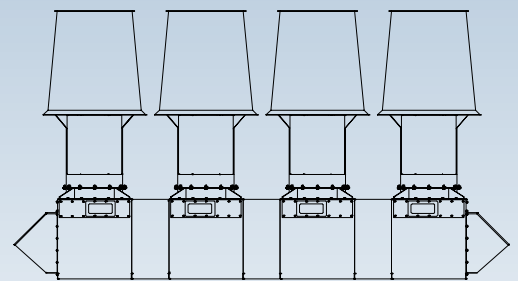

4 x 1 Quad Unit



5959 TRENTON LANE NORTH • MINNEAPOLIS, MN 55442-3237  
 PHONE: 763-551-7600 • FAX: 763-551-7601

WWW.TCF.COM